

→ According to the German EEG amendment 2009 the network operator is allowed to reduce photovoltaic plant exceeding 100kWpeak temporally. Further requirements idle power requirement will follow.

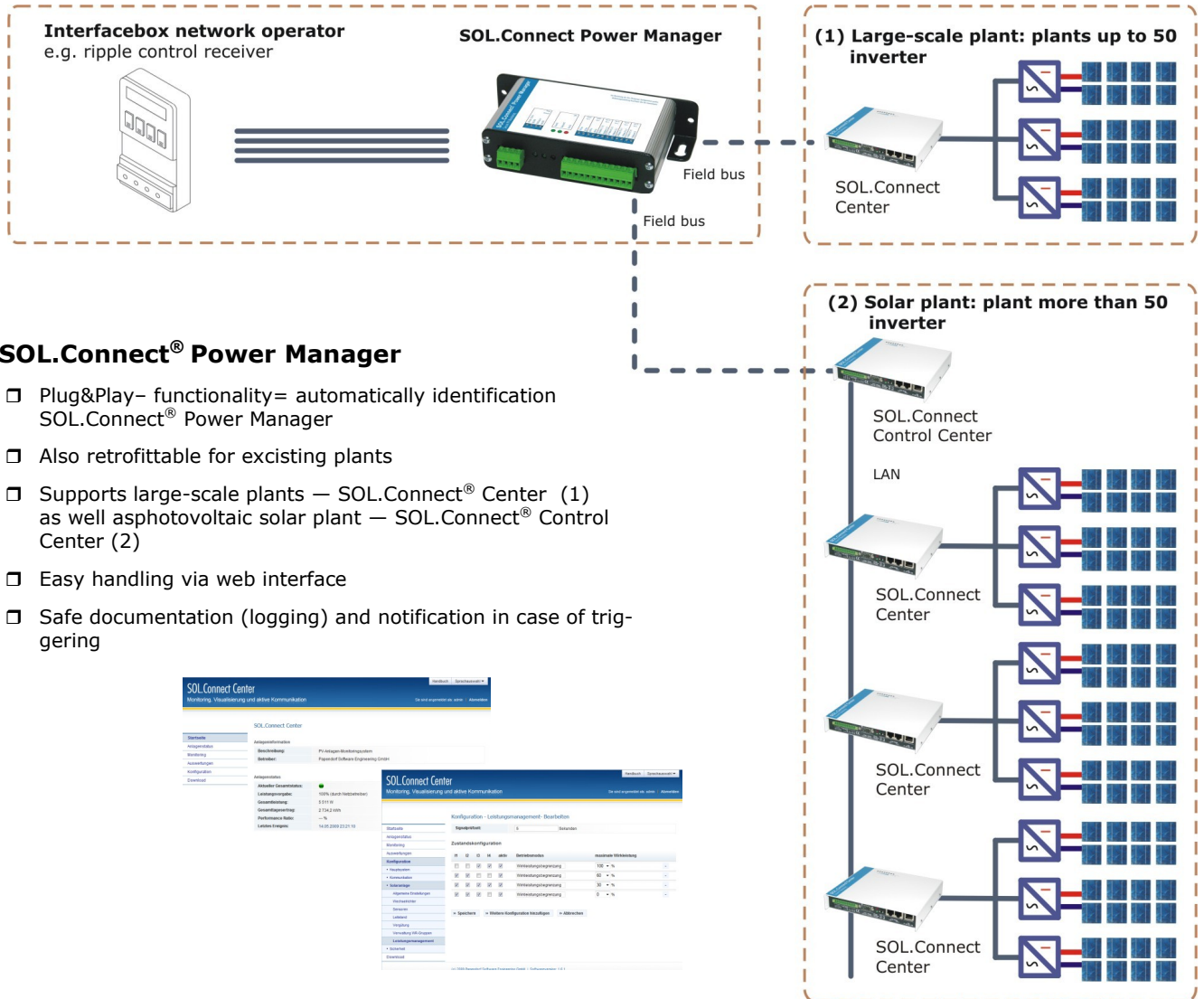

Technology

- ❑ Logging of digital interface box of the network operator
 - per passive S0-input (auxiliary supply external, galvanically isolated)
 - per active digital inputs (internal auxiliary supply , not galvanically isolated)
- ❑ Data communication per field bus „EasyLan“ up to 2000m cable length
- ❑ Power supply: 12-24Vdc, max. 40mA depending on circuit
- ❑ Operating temperature: -10°C ... +50°C
- ❑ Models:
 - IP40 aluminium profile case: 110 x 60 x 25mm (W x H x D)
 - IP65 polycarbonate: 200 x 150 x 77mm (W x H x D)
- ❑ CE- certified
- ❑ Exclusively usable with **SOL.Connect® Center** products

Partner

❑ **Functional safety** is the most important criterion. Therefore we only support inverter manufacturer in close cooperation to which Papendorf Software Engineering.



❑ Further manufacturer will follow. Feel free to contact us!